

Customer Service at 800-422-1360 (June 1, 2014)

We recommend consulting a professional if you are unfamiliar with installing bathroom fixtures.

TOOLS AND MATERIALS:

Adjustable Wrench
Circuit Tester

Damp Cloth

--	--

1/2"

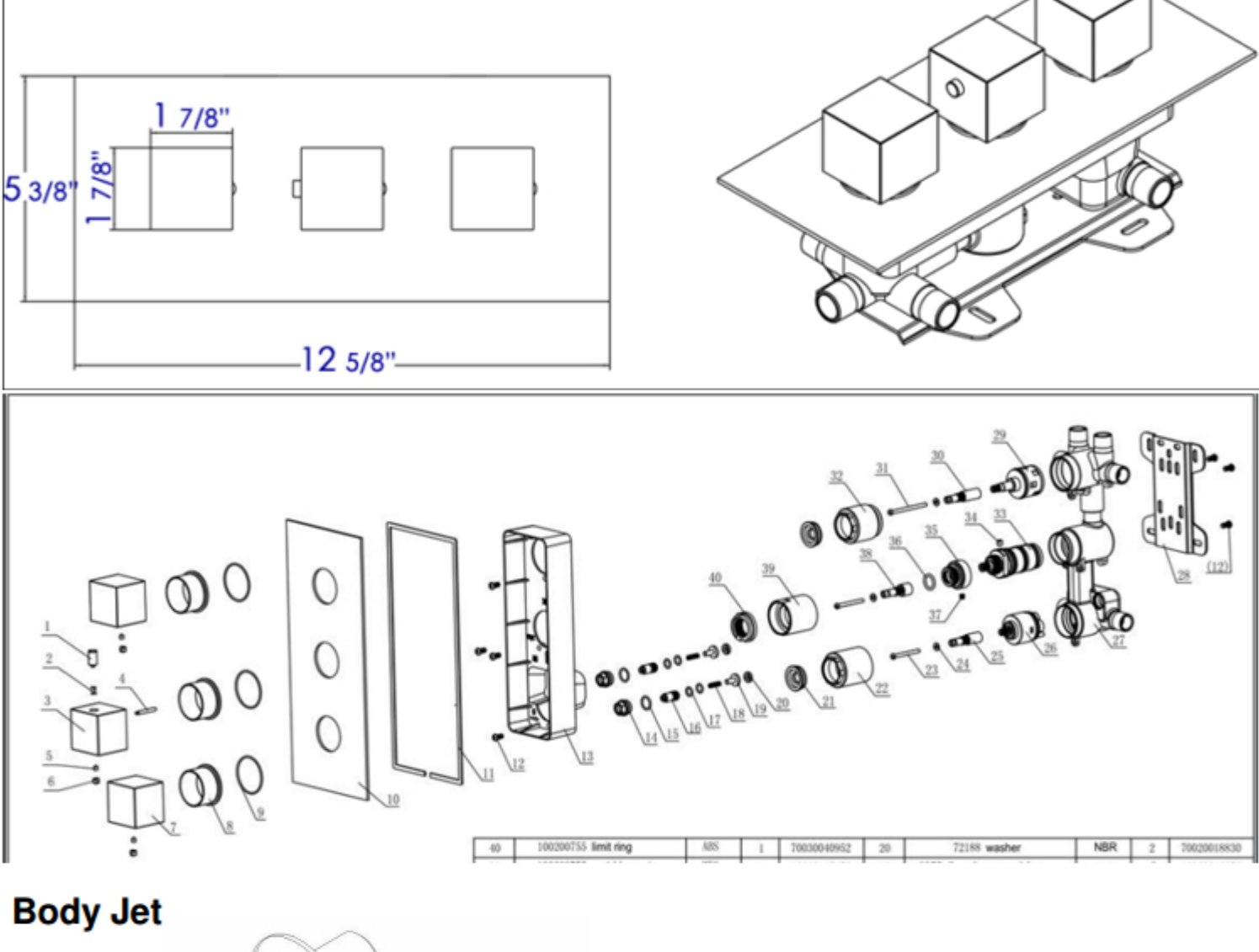

--	--	--	--	--	--

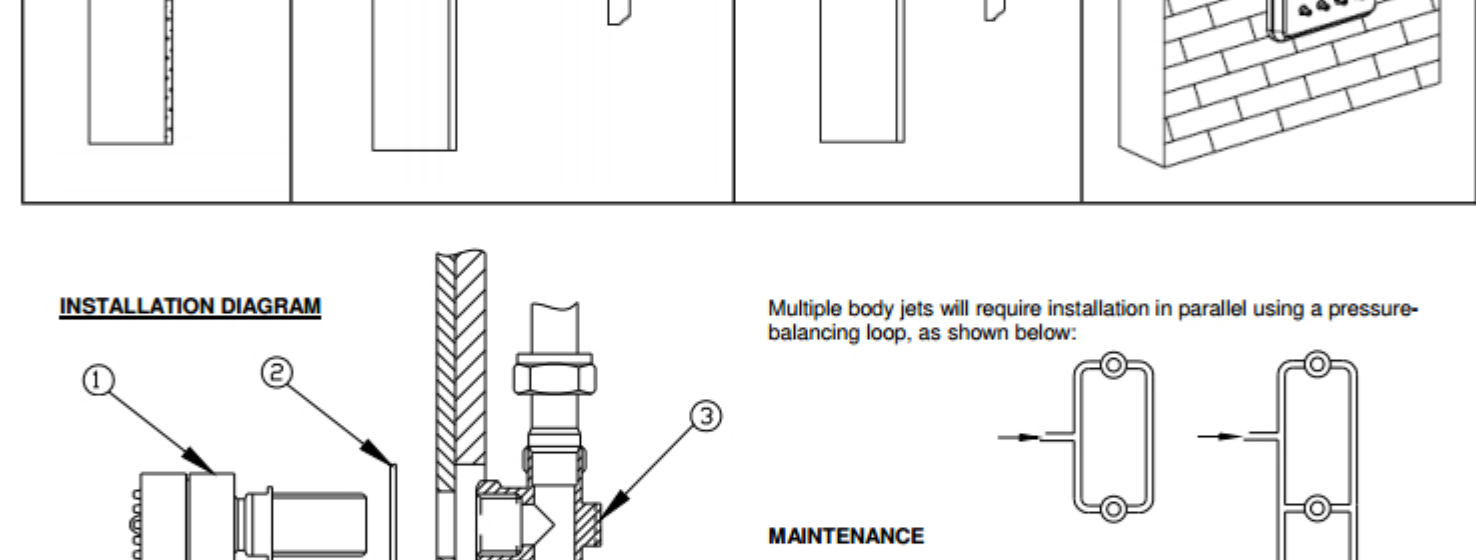

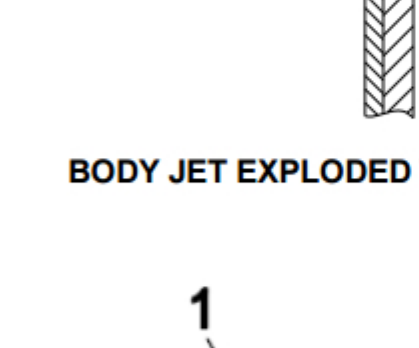

If the fitting begins to drip

1. Turn off the water supply.
2. Unscrew face plate and remove nozzle.

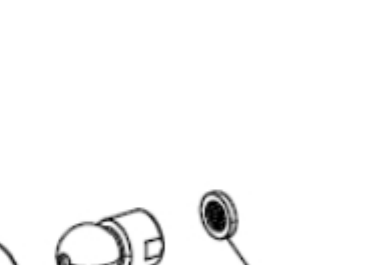
A diagram showing a vertical pipe with a circular fitting or nozzle at the bottom. The pipe is represented by two parallel vertical lines, and the fitting is a small circle at the base.

_____/

1

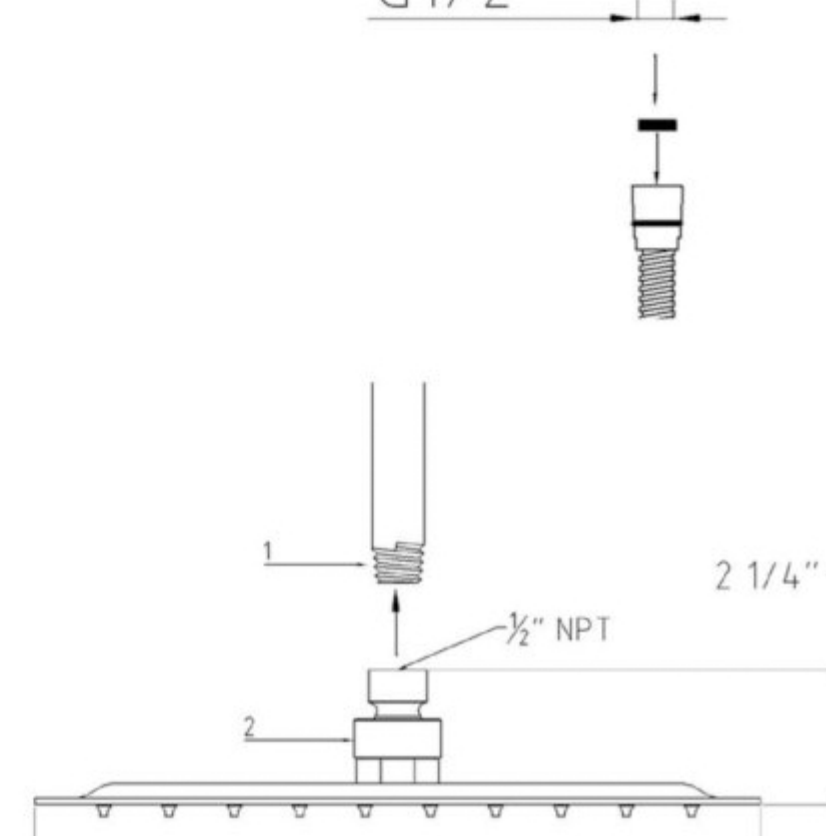
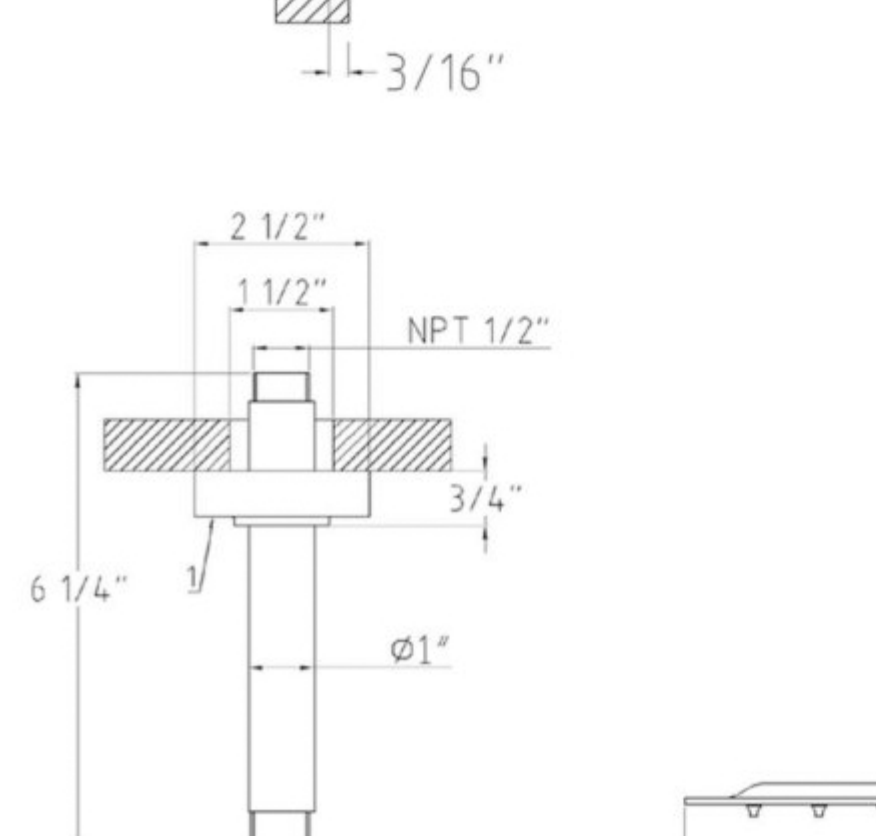
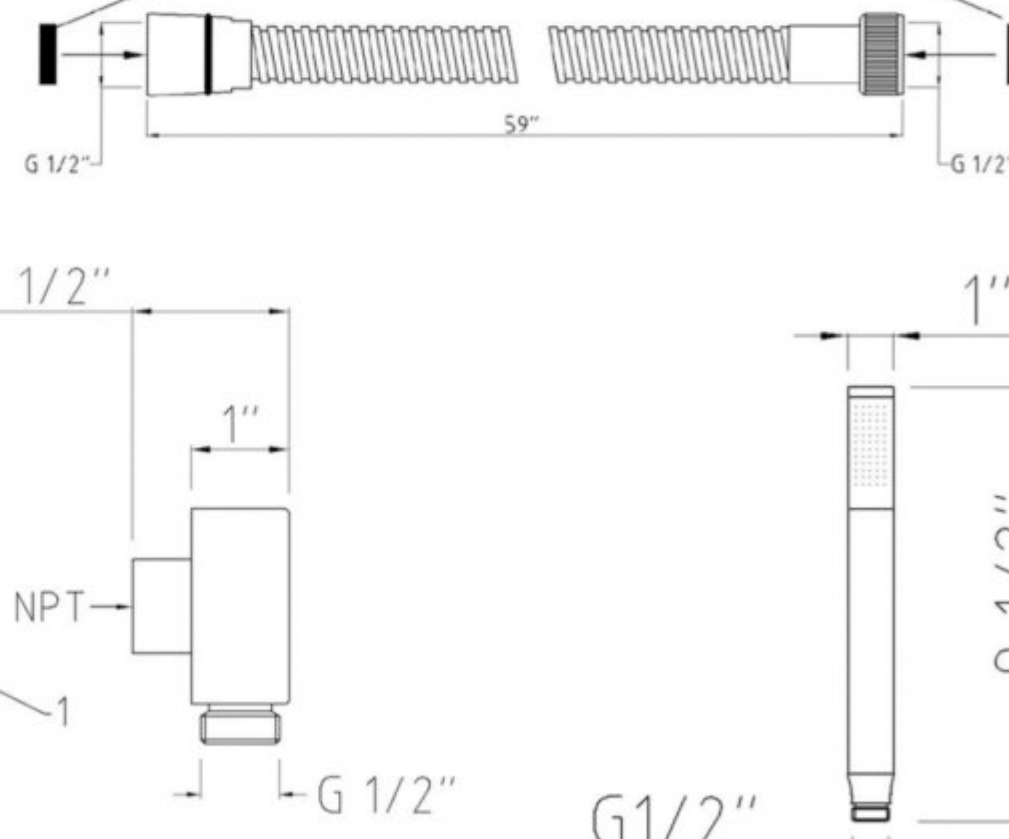
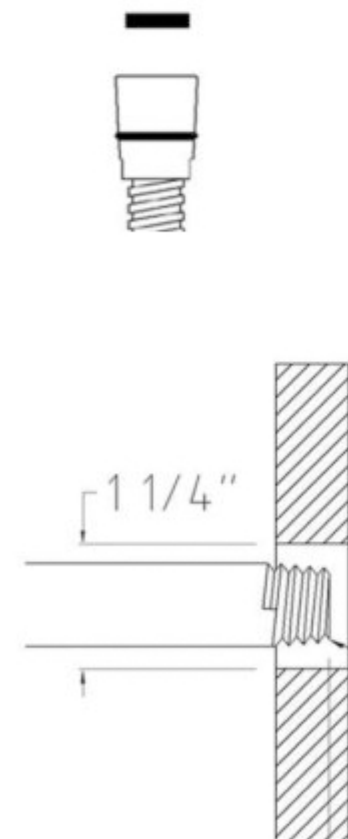
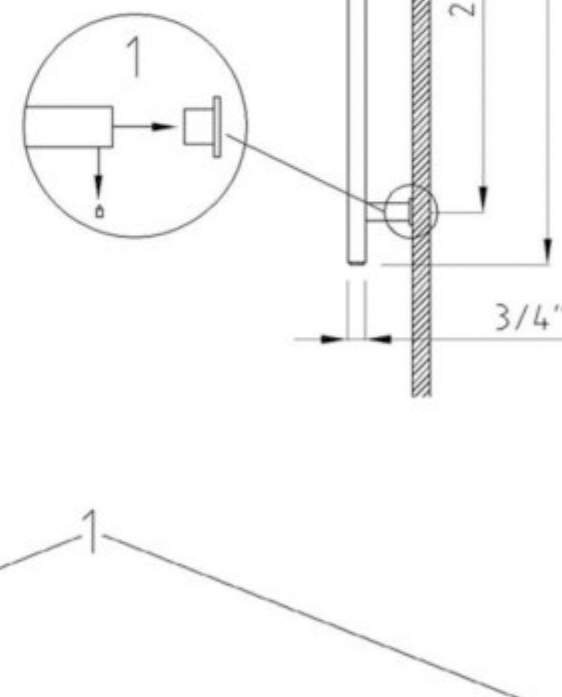
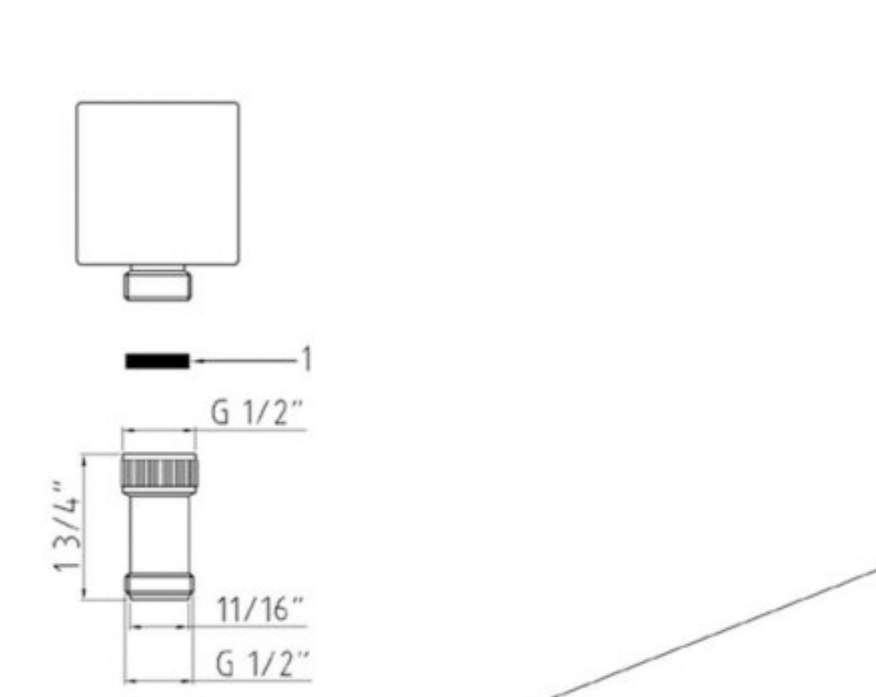
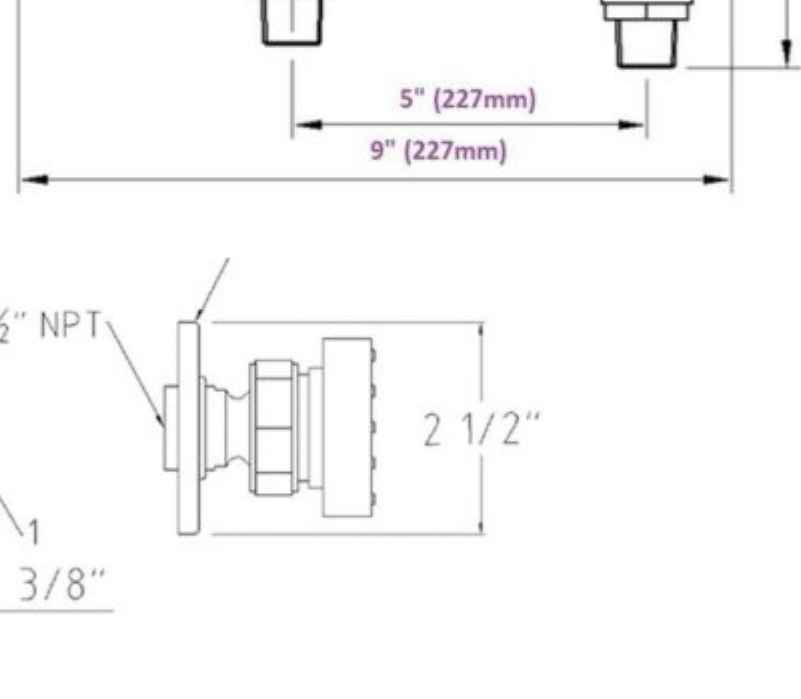
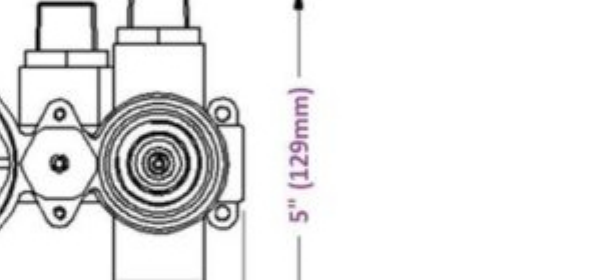
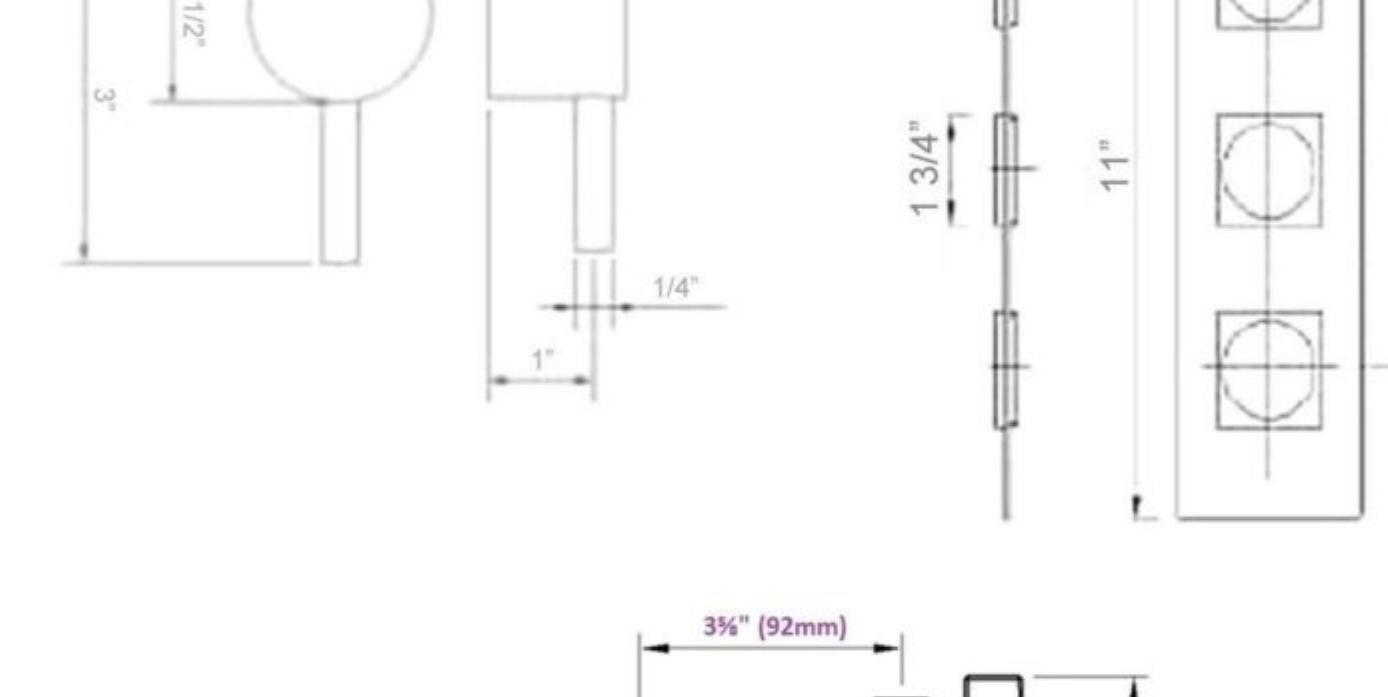
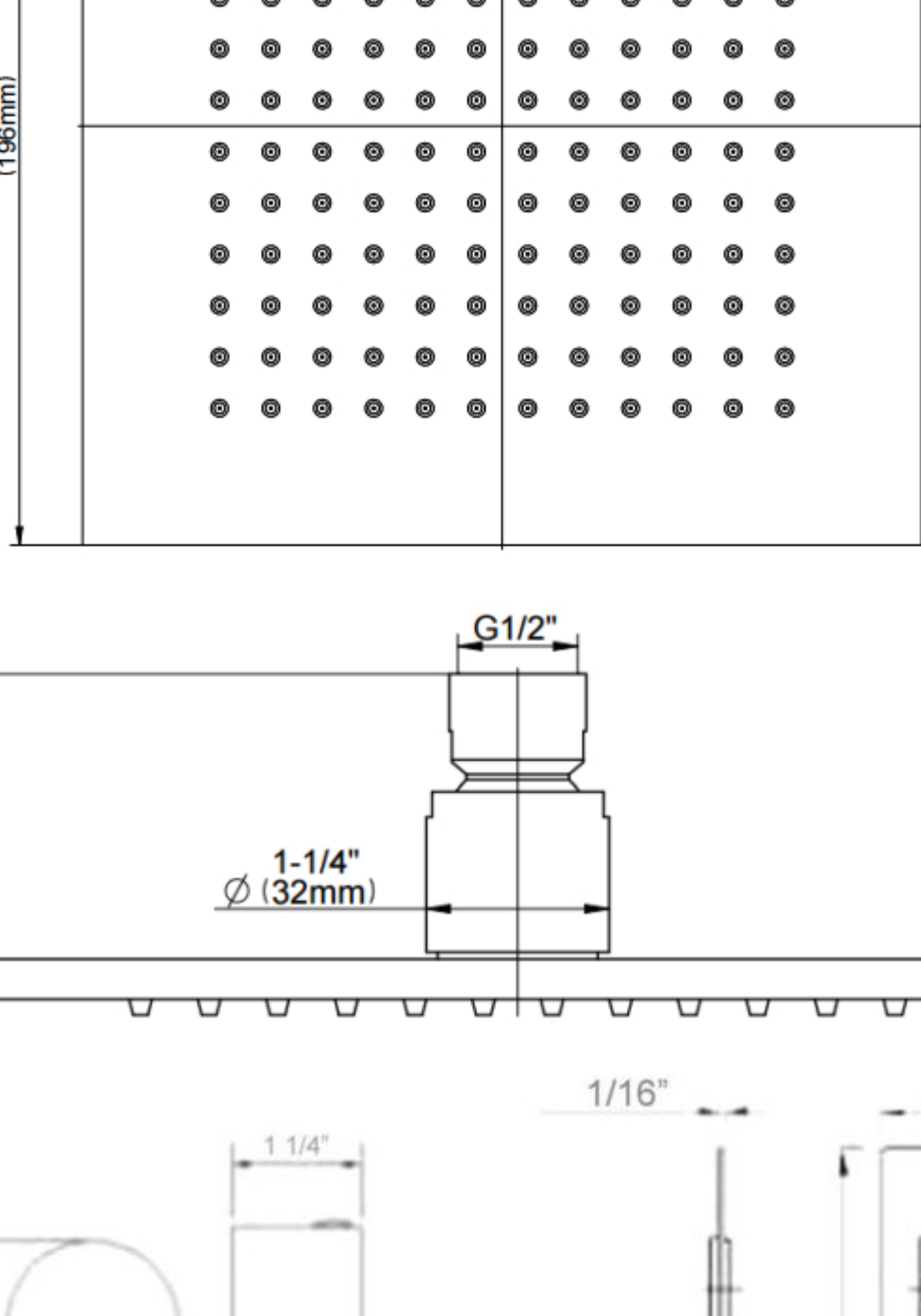
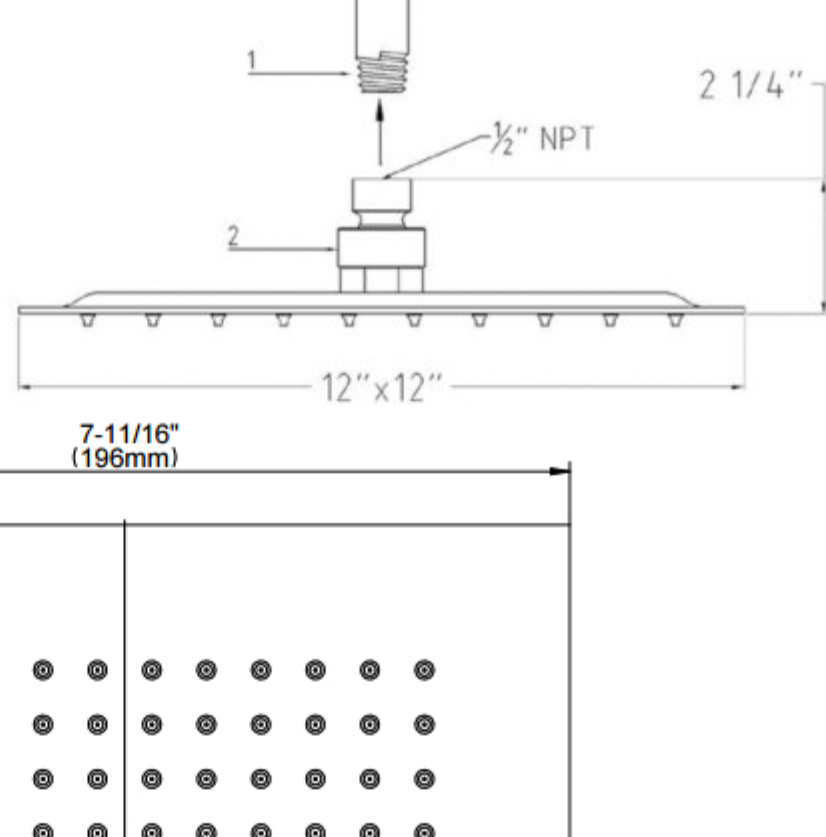
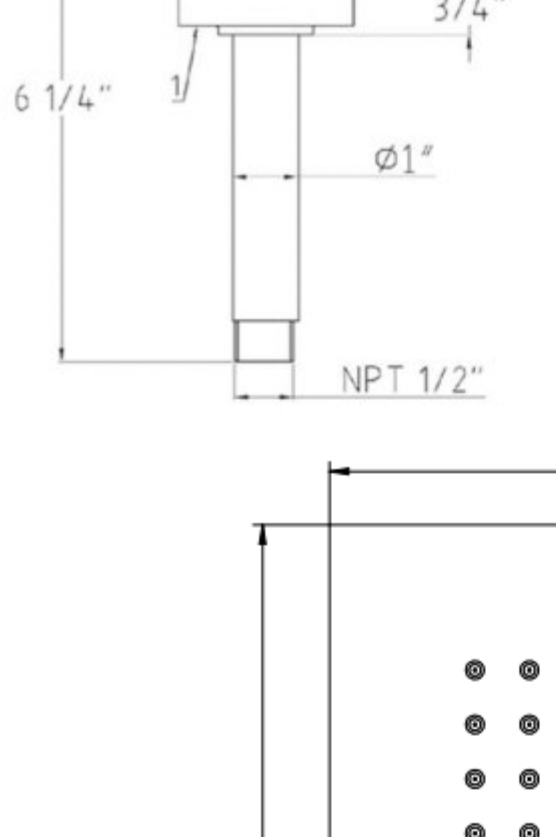
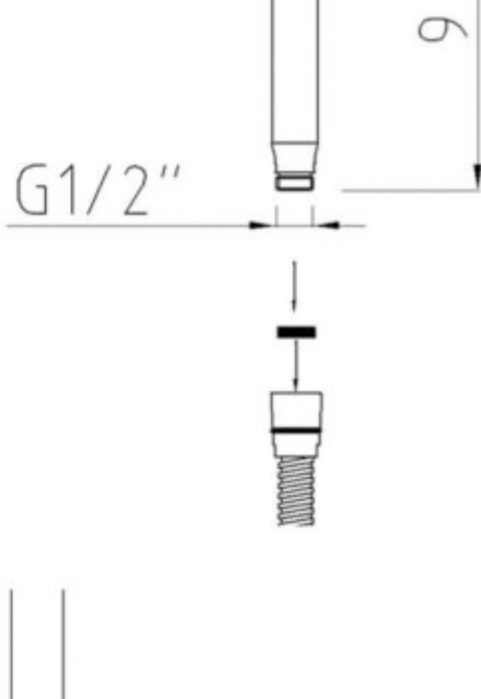
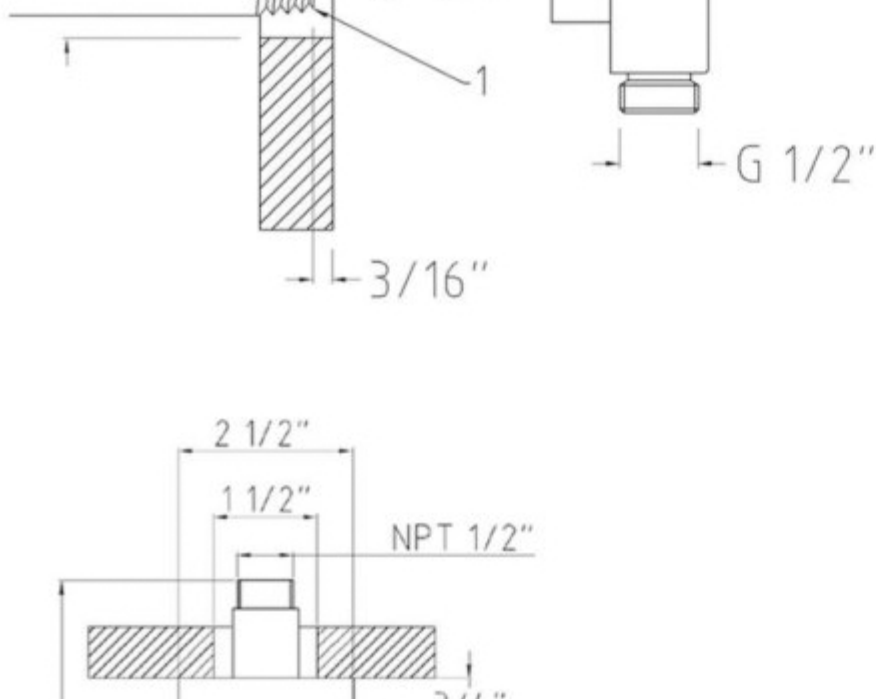
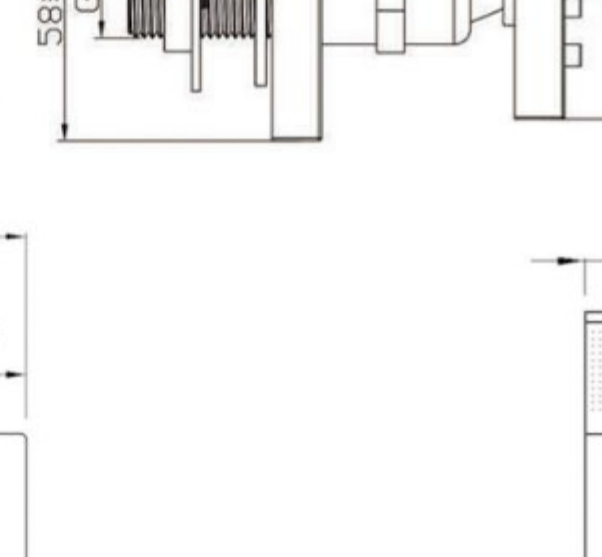
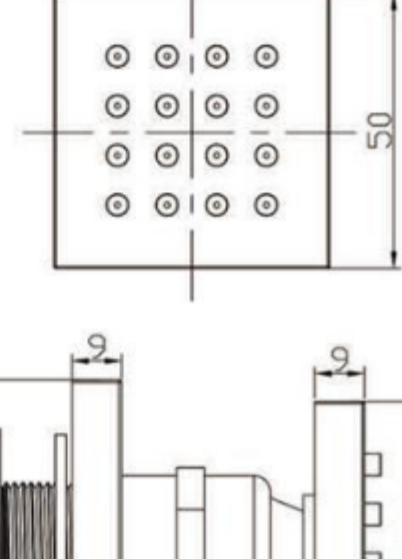
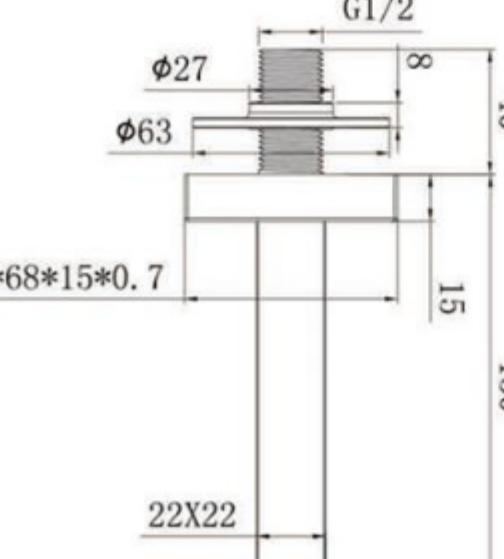
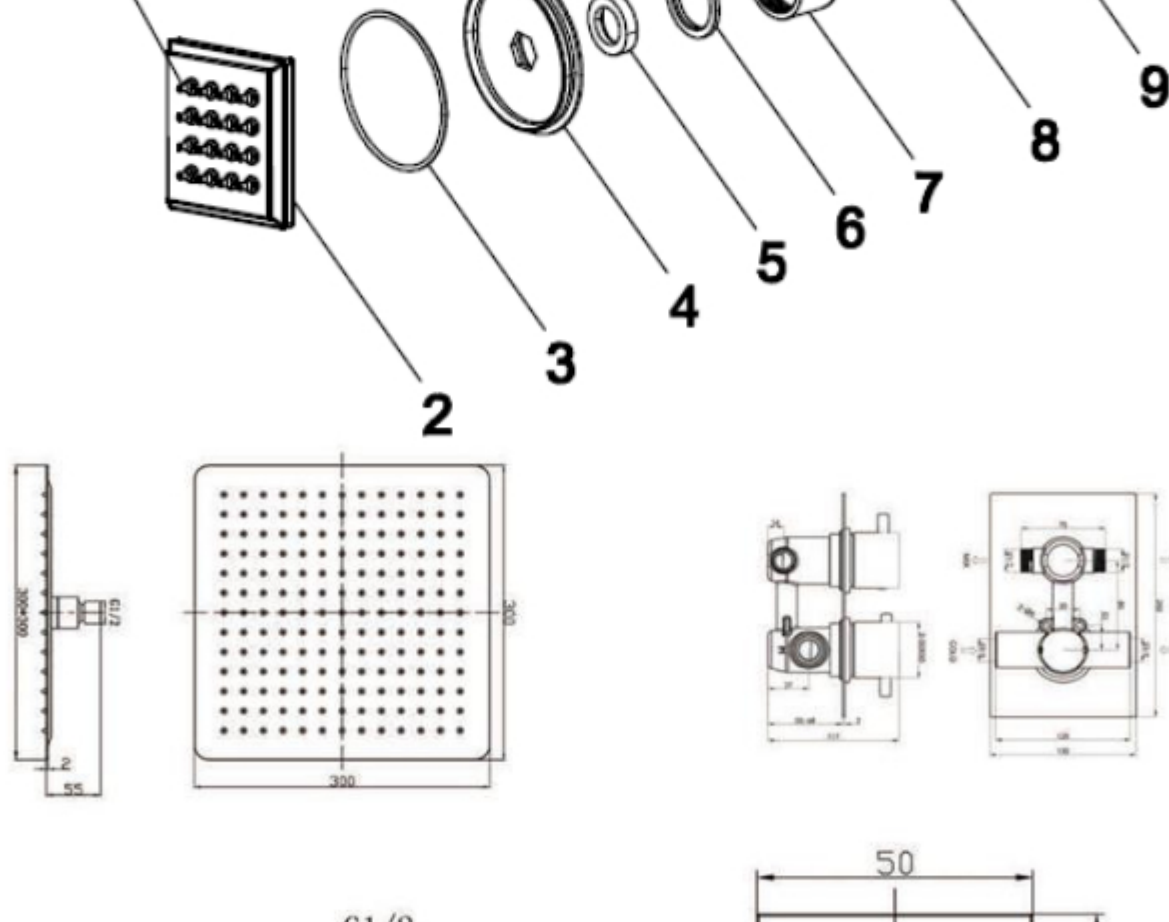

This General diagram and installation instructions are not intended for any specific